

Pin Power Inductor

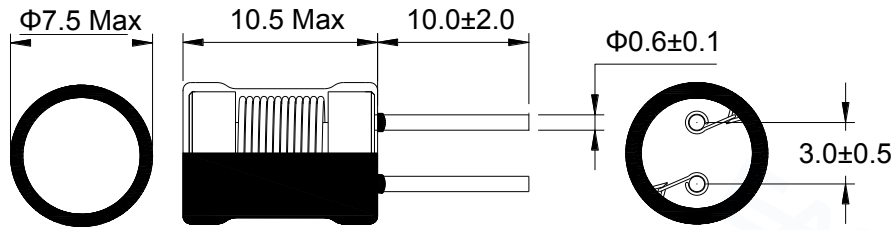

1 Appearance and dimensions (mm) 外形尺寸



2 Reference land pattern (mm) 参考基板尺寸

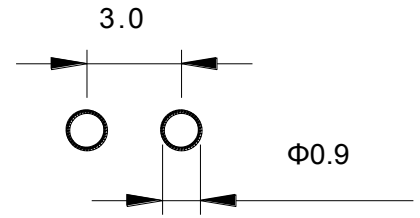

3 Electrical characteristics 电气特性

Part No. 型号	Inductance (μH) 电感值 ※1 ±10%	D.C.R. (mΩ) 直流电阻		Saturation current (A) 饱和电流 ※2		Temperature rise current (A) 温升电流 ※3
		Typical	Max	Typical	Max	Typical
DR2W0608-100K	10.0	28.3	34.0	2.40	1.92	3.54
DR2W0608-120K	12.0	31.5	37.8	2.10	1.68	3.35
DR2W0608-150K	15.0	41.0	49.2	1.95	1.56	2.94
DR2W0608-180K	18.0	48.0	57.6	1.80	1.44	2.72
DR2W0608-220K	22.0	51.8	62.2	1.55	1.24	2.61
DR2W0608-270K	27.0	68.0	81.6	1.45	1.16	2.28
DR2W0608-330K	33.0	81.9	98.3	1.27	1.02	2.08
DR2W0608-390K	39.0	101	121	1.22	0.98	1.87
DR2W0608-470K	47.0	114	137	1.10	0.88	1.76
DR2W0608-560K	56.0	134	161	1.02	0.82	1.62
DR2W0608-680K	68.0	163	196	0.96	0.77	1.47
DR2W0608-820K	82.0	239	287	0.86	0.69	1.22
DR2W0608-101K	100	263	315	0.73	0.58	1.16
DR2W0608-121K	120	298	358	0.67	0.54	1.09
DR2W0608-151K	150	386	463	0.56	0.45	0.98
DR2W0608-181K	180	443	531	0.59	0.47	0.89
DR2W0608-221K	220	530	636	0.56	0.45	0.82
DR2W0608-271K	270	653	783	0.46	0.37	0.74
DR2W0608-331K	330	789	947	0.42	0.34	0.67
DR2W0608-391K	390	981	1,177	0.36	0.29	0.60
DR2W0608-471K	470	1,104	1,325	0.35	0.28	0.55
DR2W0608-561K	560	1,356	1,627	0.32	0.26	0.50
DR2W0608-681K	680	1,561	1,873	0.29	0.23	0.46
DR2W0608-821K	820	1,881	2,257	0.27	0.22	0.42
DR2W0608-102K	1,000	2,404	2,885	0.26	0.21	0.38

All data is tested based on 25 °C ambient temperature. 所有测试数据基于环境温度25 °C条件下测试。

※1. Inductance measure condition at 1kHz, 0.25V. 电感测试条件为1kHz, 0.25V.

※2. Saturation current the actual value of DC current when the inductance decrease 20% of its initial value.
饱和电流：电感值下降其初始值的20%时所加载的实际直流电流值。

※3. Temperature rise current the actual value of DC current when the temperature rise is Δ T40 (Ta=25).
温升电流：使产品温度上升到Δ T40 °C时所加载的实际直流电流值(Ta=25 °C)